

IELTS

LISTENING

Actual Tests With Answers



EBOOK



AUDIOS



TAPESCRIPTS

JANUARY - APRIL 2022

TARGET SERIES

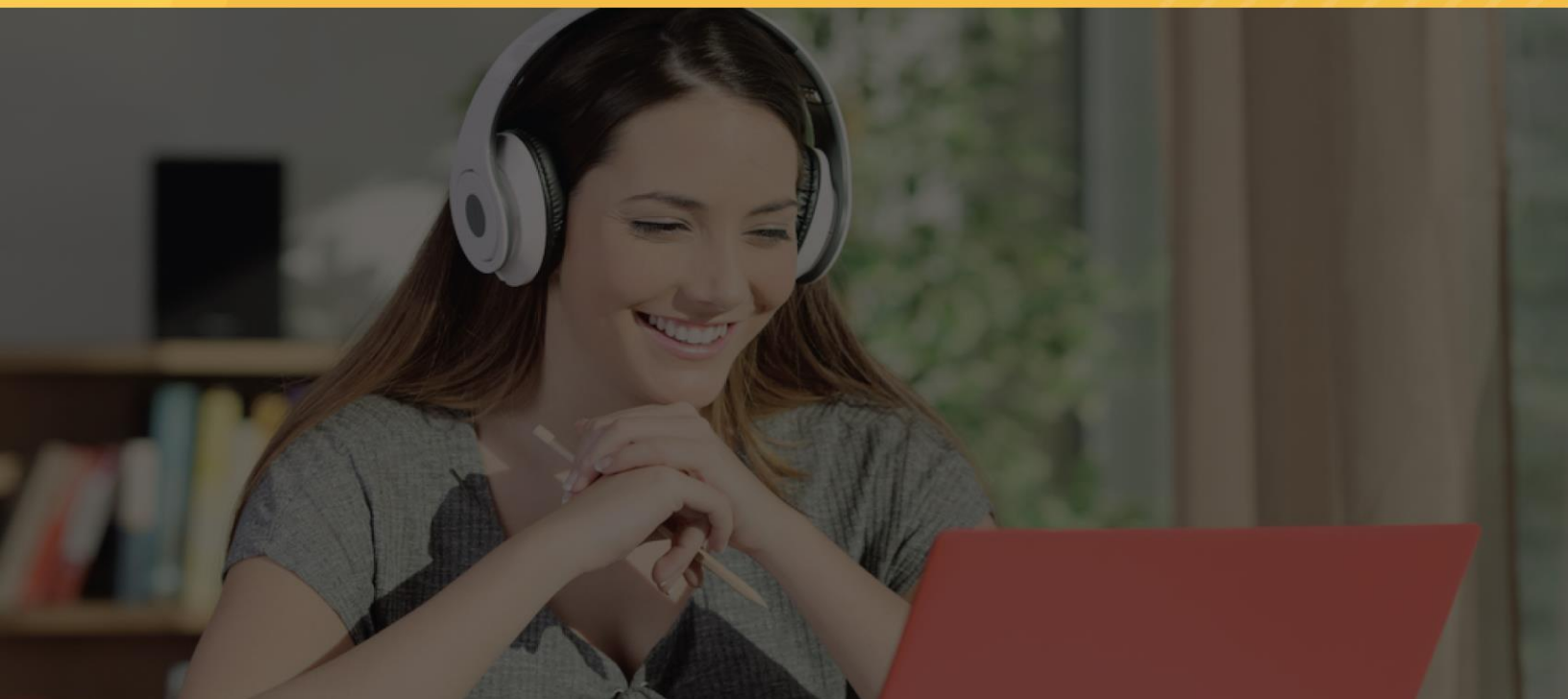

Published by

IELTSMaterial.com

This publication is in copyright. All rights are reserved, including resale rights. This e-book is sold subject to the condition that no part of this e-book may also be copied, duplicated, stored, distributed, reproduced or transmitted for any purpose in any form or by any means, electronic or mechanical, or by any information storage and retrieval system without written permission from the author.

material.com

Preface

As far as you know, IELTS candidates will have only 30 minutes (in PBT, extra 10 minutes for transferring the answers to the answer sheet) for the IELTS Listening test. There will be total of 40 questions.

Therefore, it is absolutely necessary that you invest time in practising the real IELTS Listening tests for this module.

Besides Cambridge IELTS Practice Tests series published by Oxford University Press, IELTS Listening Recent Actual Tests with Answers aims to develop both test-taking skills and language proficiency to help you achieve a high IELTS Listening score. It contains IELTS Listening Tests in the chronological order starting from the recent tests and an Answer Key. Each test contains three Listening passages which cover a rich variety of topics and give a lot of practice for a wide range of question types used in the IELTS Exam such as multiple-choice questions, short-answer questions, sentence completion, summary completion, classification, matching lists / phrases, matching paragraph headings, identification of information – True/False/Not Given, etc. When studying IELTS with this e-book, you can evaluate at the nearest possibility how difficult the IELTS Listening Section is in the real exam, and what the top most common traps are. Moreover, these tests are extracted from authentic IELTS bank source; therefore, you are in all probability to take these tests in your real examinations.

The authors are convinced that you will find IELTS Listening Recent Actual Tests extremely helpful on your path to success with the International English Language Testing System.

Don't just trust luck in your IELTS exam – the key is practice!

IELTS Material

<https://ieltsmaterial.com> | admin@ieltsmaterial.com

Table of Contents

Tips and Tricks for different question types	2
Signposting Language	5
Practice Test 1	8
Practice Test 2	17
Practice Test 3	28
Practice Test 4	38
Practice Test 5	48
Practice Test 6	56
Practice Test 7	63
Practice Test 8	71
Practice Test 9	82
Practice Test 10	91
Practice Test 11	103
Practice Test 12	115
Answer Keys	127

PR

1. Qualification / Education Assessment
2. Customized Document Checklist and Critical Document Templates (Reference Letter Templates, Self Declaration templates)
3. Filing of an online application form to create a profile for invitation and Complete express entry profile management
4. CRS score improvement guidance
5. Work experience document management so you don't face technical rejection
6. Medical Exam documents and Police Clearance certificates
7. Financial and Visa document management and processing for final PR visa

IELTS Classes (30 classes)

1. Online Based private classes: Private classes with an experienced certified trainer at your convenient time.
2. Video Content: Focused Video Content to cover exam strategies
3. Practice Exercises: Daily Practice Exercises, essay evaluations, and speaking tasks.
4. Mock Tests: Similar IELTS-like mock tests.
5. E-books - With the last 1 year IELTS question bank for practice.

Job Search Assistance

1. Revamping your resume to international standards
2. LinkedIn profile optimization
3. Marketing your profile to the directory of employers and recruitment consultants

Service	₹50,000	₹60,000	₹65,000	₹75,000
PR	✓	✓	✓	✓
IELTS Classes (30 classes)	✗	✗	✓	✓
Job Search Assistance	✗	✓	✗	✓

✓ Spouse Pricing: - ECA - 10K INR - Job Search Assistance - 10k INR

BOOK YOUR CONSULTATION NOW

As a part of IELTSMaterial family, you can avail extra benefit / discounts when you opt for Canadian PR process with us

Telegram - @officialieltsreality



IELTS Listening Test

Tips and Tricks for different question types

Types of questions in IELTS Listening

- Multiple choice questions
- Map Labelling questions
- Sentence Completion/Note completion/ Table completion/Diagram completion questions
- Match questions

Let's look at the tips and tricks required to answer each question type:

Multiple Choice Questions

While listening to the audio recording there will be a section for multiple-choice questions. The multiple-choice questions are of two types –

- Multiple choice questions with one answer.
- Multiple choice question with two or more answers

There are questions that have one or more answers, for those type of questions, you would have to listen keenly to identify all the answers from the options given.

There are a few things you would have to keep in mind while you're answering multiple-choice questions:

- You will hear all the options that are given to you in the question. You would have to listen to the audio and interpret the answer from what is asked in the question.



- Sometimes, the answer options might be of the same kind to confuse you. For instance, it might all be in the form of dates (15 November, 17 November or 18 November). You would have to read the question and choose the correct answer.
- The words used in the question might not be the exact words that you hear in the audio recording. So, you'd have to pay attention to synonyms and how the words are paraphrased.
- The information provided in the audio recording might not be in the same order as the questions asked, so in order to answer the questions correctly, you should have read the questions beforehand to be aware of what is being asked.
- There would be a lot of distractors in the audio recording. There would be a lot of the same kind of information. Sometimes, the speaker might give us any information and then change it which might be the correct answer. So, do not rush and write down the answer as soon as you hear it.

Map Labelling questions

For these types of questions, you would be provided with a map and you would have to label the places on the map.

There are two types of questions:

1. A list of words might be given to you and you'd have to listen to the recording and choose the correct word that fits the blank on the map.
2. There won't be a list, you would just listen to the audio and identify the place on the map.

There are a few things you would have to keep in mind while you're answering Map Labeling questions:

- There would be directions to a place or some kind of tour.
- Read the instructions before you begin, so that you'll know the word limit of the blanks.
- Description of the location – listen to words that best describe the location given. For example, below the park, next to the supermarket, etc.
- Look at the question numbers – Look at the question numbers and identify the flow of the map. That would help you listen to what's coming next.
- The audio recording would provide you with an understanding of where you are or where you have to begin at. Pay attention to it at the beginning of the recording. Also, listen to nearby places and clues to help find the answers.



Sentence Completion/Note completion/ Table completion/Diagram completion questions

In some of the questions, there will be a gap left in between and the examiner asks you to fill that gap. In order to guess the word correctly, you must have solid grammar skills.

There are a few things you would have to keep in mind while you're answering sentence (and other completion) questions:

- Read the question before you start in order to understand what you should be listening for.
- Try to guess what would come in the blank. It could be a place, a number, year, name or even a specific range of information (such as seasons, climatic conditions)
- The words in the question need not necessarily be the same words you hear in the audio recordings, learn to tune yourself to synonyms of the words in the question.
- Though the questions might be phrased differently from the recordings, the answers should be the exact words you hear in the audio.
- Remember to check the word count, spelling and grammar before you transfer your answers to the answer sheet.

Match questions

These questions are not as common as the other question types but they do occur in the Listening section. These questions have a list of statements that you'd have to match with the options provided. Mostly it would be names, places or dates.

There are a few things you would have to keep in mind while you're answering Match questions:

- Look at the statements and listen keenly to the kind of information that has been provided as options. (i.e) if the options are dates, listen keenly to all the dates in the audio.



- By the side, write down all the information linked to that particular option, it would make it easier for you to find the answer.

Signposting Language

What is a signposting language?

Signposting means using phrases and words to guide the reader through the content of a passage or a recording. In this case, it's an audio recording. With the help of these phrases and words, the listener can anticipate what's next and find the answer.

Signposting examples:

Purpose	Signposting language
Introduction to the lesson/lecture	<ul style="list-style-type: none"> • The purpose of today's lecture is... • The subject/topic of my talk is ... • The lecture will outline ... • The talk will focus on ... • Today I'll be talking about / discussing...



	<ul style="list-style-type: none"> ● Today we are going to talk about... ● The topic of today's lecture is...
Describing the structure of the lecture	<ul style="list-style-type: none"> ● I'm going to divide this talk into a few parts. ● First, we'll look at..... Then we'll go on to ... And finally I'll...
Introducing the topic/ first point / first section	<ul style="list-style-type: none"> ● Let's start by talking about... ● To begin,... ● Firstly,...
Starting an idea or linking to another idea	<ul style="list-style-type: none"> ● Let's move on to... ● Now, let's turn to... ● And I'd now like to talk about... ● Building on from the idea that ..., ● Another line of thought on ... demonstrates that ... ● Having established ...,



To reach the end of the talk / Summing up

- In conclusion, ...
- From the above, it is clear that
...
- Several conclusions emerge from this analysis ...
- To summarise, ...
- I'd like now to recap...





Practice Test 1

Instructions to follow

- Listen to the [audio](#) and answer the questions below

Part 1

Questions 1-5

Instructions to follow

- Complete the form below.
- Write NO MORE THAN TWO WORDS AND/OR A NUMBER for each answer.

Clean-it Customer Survey Form

Customer Name: Mr. Sargent

Model purchased ①

Date of purchase ②

Salesperson Jim. Very pleased with service and product knowledge.

Any other products purchased? vacuum cleaner bags, ③

Amount spent in store £. ④

Quality of product(s) purchased Very pleased

Any purchases from competitors? Ezi-clean, ⑤and Johnston Bros.



Questions 6-10

Instructions to follow

- Complete the notes below
- Write NO MORE THAN TWO WORDS AND/OR A NUMBER for each answer.

How would you rate the quality of our service? **6** _____

Best day(s) and time to visit the store? Sundays between **7** _____ and _____
pm

8 _____ between 11 and 12 noon

Suggestions for improvement

Turn up the **9** _____

Have some **10** _____ in the store



Part 2

Questions 11-16

Instructions to follow

- Complete the table.
- Write NO MORE THAN TWO WORDS for each answer.

Advantages of Stanfield Childcare Centre

Advantages of Stanfield Childcare Centre			
	1	2	3
Detail	Walls are _____ 11	Teachers are able to teach a _____ 12	They _____ 13 surface daily
Another detail	Includes the _____ 14	There are many special _____ 15	Procedures to limit the spread of _____ 16

Questions 17-20

Instructions to follow

- Choose the correct letter, A, B, or C.
- NB You may use a letter more than once.



Which childcare worker:

- A Andrea
- B Bella
- C Cathy

17 _____ has her own children?

- A
- B
- C

18 _____ often sleeps at the center?

- A
- B
- C

19 _____ is good with shy children?

- A
- B
- C

20 _____ is a good cook?

- A
- B
- C



Part 3

Questions 21-24

Instructions to follow

- Complete the notes below.
- Write NO MORE THAN TWO WORDS AND/OR A NUMBER for each answer.

- The students must make a 21 presentation on Eastern Europe.
- This presentation has to be 22 minutes long.
- Afterwards, there will be a ten-minute 23 and answer session.
- The students will also be graded on this.
- The students must also hand in a synopsis of their presentation 24 beforehand.
It has to be 500 words long.

Questions 25-26

Instructions to follow

- Choose TWO letters A-E.

What are the TWO disadvantages of making a slideshow for the presentation?

- A The software for making slideshows is hard to use.
- B The time making a slideshow could be spent researching and studying.
- C It is hard to find the right equipment to display slide shows.
- D Slide shows are distracting and take away from what people are saying.



E Professors prefer presentations without visual aids.

25 _____

- A B C D E

26 _____

- A B C D E

Questions 27-30

Instructions to follow

- Complete the table below.
- Write NO MORE THAN ONE WORD OR A NUMBER for each answer.

Author	Title	Publisher	Year publisher
* _____ 27 _____	*The political economy	*_	*_
*Smith	*An _____ 28 _____ in transition	* _____ 29 _____ *Press	*_
*Brown	*Foisted into power		* _____ 30 _____



Part 4

Questions 31–40

Questions 31-33

Instructions to follow

- Complete the summary below.
- Write NO MORE THAN TWO WORDS for each answer.

If soil is healthy, it is a³¹..... teeming with life such as worms, fungi and bacteria. If plants are grown in poor soil, they will lack³²..... and human health will suffer. Plants are nourished by organic matter,³³..... and other essential elements which are broken down by insects and other organisms in a synergistic relationship.

Questions 34-36

Instructions to follow

- Label the diagram below. Write NO MORE THAN TWO WORDS for each answer.



Layers of Soil

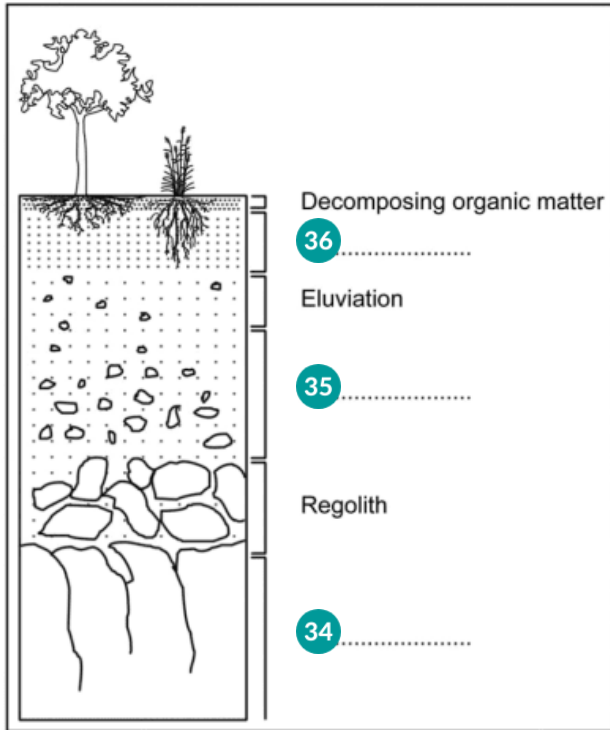

Questions 37-40

Instructions to follow

- Complete the notes below. Write NO MORE THAN TWO WORDS for each answer.

Problems:

- Erosion
-³⁷..... from various sources, including chemical fertilisers



Conventional Farming Methods	Organic farming methods
<p>*monoculture</p> <p>*synthetic fertilizer & chemicals used for _____ 38 _____</p> <p>*genetically-modified seeds</p> <p>*pesticide & fungicide sprayed on crops after picking</p> <p>*no need for documentation of _____ 39 _____</p>	<p>*crop rotation</p> <p>*covering crops</p> <p>*use of insects as natural _____ 40 _____</p> <p>*additional of manure & green waste</p>



Practice Test 2

Instructions to follow

 Listen to the [audio](#) and answer the questions below

Part 1

Questions 1-3

Instructions to follow

Choose the correct letter A, B, C.

1 How long is the heated pool?

- 
- A 15 meters
 - B 25 meters
 - C 50 meters

2 Which of these is free for all members?

- A the beginners swimming class
- B the training session
- C the keep-fit class

3 Which of these does the woman need to book?

- A swimming lanes
- B gym equipment
- C sauna



Questions 4-10

Instructions to follow

- Complete the notes below. Write **NO MORE THAN THREE WORDS AND/ OR A NUMBER** for each answer.

Yoga classes

- Held on Monday, 4 and _____ mornings
- Weekend evenings from 5 to _____
- Attend 6 per week
- See instructor to change 7
- Cost £1.50
- Meet John 8
- Office located on first floor
- Meet at 9
- Telephone: 10



Part 2

Questions 11-15

Instructions to follow

- Choose the correct letter, **A**, **B** or **C**.

11 Why does the speaker recommend the Sky Hotel?

- A Because it is quite comfortable.
- B Because it provides ski and snowboard equipment rentals.
- C Because it has a health and sports club.

12 What is new in this year's exhibition?



- A photos of top ski resorts worldwide
- B ski equipment
- C computer simulation

13 How do people enter the skiing and snowboarding competition?

- A They can send emails to the committee.
- B They can fill out the back of the entrance ticket.
- C They can check out the exhibition newsletter

14 What did the media focus on this year?

- A not enough snow
- B reduction in fee
- A the decline of participants

15 Why does the speaker recommend the ski program?

- A The instructors are quite friendly and patient.



- B It includes lessons and sessions that suit only beginners
- C It provides special offers at the moment.

Questions 16-20

Instructions to follow

- Choose **FIVE** answers from the box and write the correct letter, **A-F**, next to Questions **16-20**.

What is the focus of each presentation?

- A exploring new destinations
- B how to make the skiing boots comfortable
- C how to become a ski instructor
- D how to combine other activities with skiing
- E how to improve the skills of skiing
- F information about skiing safety

Presentation

16 Simon's talk

- A B C D E F

17 Solution

- A B C D E F

18 Film



- A
- B
- C
- D
- E
- F

19 Tricks

- A
- B
- C
- D
- E
- F

20 Johnson's talk

- A
- B
- C
- D
- E
- F





Part 3

Questions 21-24

Instructions to follow

Choose the correct letter, A, B or C.

- 21 The course has improved the environment since
- A it was regulated by law.
 - B more students were involved.
 - C more species were brought from other places
- 22 What is the biggest reason why the organisation improved greatly?
- A It was funded by a private investor
 - B It sold out its shares.
 - C It got the governmental fund in the first year
- 23 What is suggested from the reports?
- A Resources still need management.
 - B Teachers and the students have benefitted from the field trips.
 - C The environment has been terribly damaged.
- 24 Who did obtain the special experience from the field trip carried out by the organisation?
- A students



- B teachers
- C researchers

Questions 25-26

Instructions to follow

- Choose TWO letters, A-E.

What TWO problems does the report focus on?

- A air pollution
- B soil erosion
- C overgrazing
- D forest exploitation
- E water pollution

IELTSMaterial.com

25 _____

- A
- B
- C
- D
- E

26 _____

- A
- B
- C
- D
- E

Questions 27-28

Instructions to follow

- Choose TWO letters, A-E.



Which TWO benefits of this activity to the students are mentioned by the professor?

- A They become more punctual.
- B They feel more confident.
- C They get practical experience.
- D They learn how to collect data.
- E They know the importance of environment protection.

27 _____

- A B C D E

28 _____

- A B C D E

Questions 29-30

Instructions to follow

- Choose TWO letters, A-E.

What TWO things will the woman do in the rest of the time when no activities are going on?

- A read more reference books
- B study in library
- C interview some teachers
- D participate in one of fun hobbies
- E join in some tutorials Complete the notes below.



29 _____

- A B C D E

30 _____

- A B C D E





Part 4

Questions 31-35

Instructions to follow

- Complete the notes below.
- Write **NO MORE THAN TWO WORDS** for each answer.

History of time-measurement

Primitive measurements by observing

Two time keepers:

- The **31**
- Natural events, such as winds and rains, rivers flooding, plants flowering, and the cycles of breeding or **32** behaviour.

Precise measurements

They became important for organising activities for:

- **33**
- **34**

The oldest time keepers were discovered in Mesopotamia and **35**



Questions 36-40

Instructions to follow

- Complete the table below.
- Write **ONE WORD ONLY** for each answer.

Time Keeper	Disadvantages
The sundial	In different parts of the year, the time for day ³⁶
The clepsydra (Water clock)	The changing pressure and ³⁷ were what the flow of water still relied on.
The ³⁸	The time duration was ³⁹
Fire candle clock	The burning ⁴⁰ or the rate of burning, was subject to the candles wax.



Practice Test 3

Instructions to follow
 Listen to the [audio](#) and answer the questions below

Part 1

Questions 1-6

Instructions to follow

- Complete the notes below.
- Write NO MORE THAN ONE WORD AND/ OR A NUMBER for each answer.

Address: 1, Yeronga Street, 1

Postcode: 4105

Telephone No. (Work) : N/A
 (home): 2

Respondent: 3

Trading name: ABC appliances ltd

Address: 4 avenue, Bardon

Postcode: 5

Telephone no. (work): 72324681

Date (of transaction): 3/2/2011





Warranty/Guarantee: _____ **6** _____

Questions 7-10

Instructions to follow

- Complete the notes below. Write NO MORE THAN TWO WORDS AND/ OR A NUMBER for each answer.

Full particulars of claim

Good: _____ **7** _____ – ('Mallard' brand, 'Whisper' model, serial no. XY303)

Agreed to pay: _____ **8** _____ £

Good delivered on 5/3/2011

ABC appliances picked up the trade in on the same date.

Salesman said: Mallard Whisper model

- Uses less energy because it has shorter cycle
- Reduces the amount of _____ **9** _____ used
- Whisper quiet

Complaint: the cycle is longer and the appliance is very _____ **10** _____



Part 2

Questions 11-14

Instructions to follow

- Choose the correct letter A, B or C.

11 Jack says that in London these days many people

- A see cycling as a foolish activity
- B have on experience of cycling
- C take too many risks when cycling

12 If people want to cycle to school or work, CitiCyclist helps them by

- A giving cycling lessons on the route they take.
- B advising them on the safest route to choose.
- C teaching them basic skills on quiet roads first.

13 Jack works with some advanced cyclists who want to develop

- A international competitive riding skills.
- B knowledge of advanced equipment.
- C confidence in complex road systems.

14 CitiCyclist supports the view that cyclists should



- A have separate sections of the road from motor traffic.
- B always wear protective clothing when cycling.
- C know how to ride confidently on busy roads.

Questions 15-17

Instructions to follow

- Choose THREE types of organizations for which CitiCyclist provides services.

- A training courses
- B schools
- C local councils
- D individuals
- E companies

IELTSMaterial.com

15 _____

- A B C D E

16 _____

- A B C D E

17 _____

- A B C D E



Questions 18-20

Instructions to follow

- Complete the notes below. Write NO MORE THAN THREE WORDS AND OR A NUMBER for each answer.

Website address: citicyclist.co.uk

Phone: _____ **18** _____

Cost (single person): _____ **19** _____ per person

Usual length of course: _____ **20** _____ except complete beginners)





Part 3

Questions 21-24

Instructions to follow

- Complete the table showing the modules Zeo is taking or considering taking this semester.

- A = Accountancy
 B = Banking and Finance
 E = Economic
 I = Introduction to Economics
 P = Principles of Financial Accounting
 M = Principles of Marketing

21.....

A B E I P M

22.....

A B E I P M

23.....

A B E I P M

24.....

A B E I P M



Questions 25-28

Instructions to follow

- Complete the information below.
- Write ONE WORD ONLY for each answer.

- 25 Zeo is worried about doing a type of mathematics called
- 26 Her adviser recommends she do a brush-up
- 27 Zeo needs to develop the reading skills of skimming and
- 28 The course develops these skills through a series of specially-designed

Questions 29-30

Instructions to follow

- Choose the correct letters, A to D.

- 29 Zeo's adviser recommends she learn the
- A Academic Vocabulary List
- B The Academic Word List
- C The General Word List
- D Academic Resource List
- 30 The list contains
- A 517 words
- B 970 collocations



- C 570 word families
- D 2000 words





Part 4

Questions 31-36

Instructions to follow

- Write ONE WORD ONLY for each answer.

_____ **31** _____ a currency

Imagine you need to _____ **32** _____ 100 pounds.

_____ **33** _____ facts about the state of your country's economy

Look at other students' notes on their countries

Decide what your exchange 'rate' is going to be against each currency

Try to _____ **34** _____ your currency

_____ **35** _____ other currency if you want

_____ **36** _____ your profit

Questions 37-40

Instructions to follow

- Answer the questions below.
- Write NO MORE THAN TWO WORDS AND/OR A NUMBER for each answer.



37 How many main trading partners does the UK have?

38 Which sector does the tutor want students to study?

39 What does the tutor want students to look at?

40 When does the tutor want the project completed?





Practice Test 4

Instructions to follow
 Listen to the [audio](#) and answer the questions below

Part 1

Questions 1-5

Instructions to follow

- Complete the form below.
- Write NO MORE THAN THREE WORDS OR A NUMBER for each answer.



Cheapies Car Hire

Rental Form

Customer's Name	Mr. John Wilson
Customer's Address ¹
	Manchester
Postcode	MW7 4DF
Home Tel.	020 6834 6387
Mobile Tel. ²
Driving Licence No. ³
Number of Drivers	1
Length of Rental ⁴days
Car Make Chosen ⁵





Questions 6-8

Instructions to follow

- Complete the Cheapies Customer Information Leaflet below.
- Write NO MORE THAN THREE WORDS OR SOME NUMBERS for each answer.

Cheapies Customer Information Leaflet

Dear Sir/Madam

Thank you for hiring a car from Cheapies. We value your custom and we will endeavour to provide you with the service that you expect.

Total Price 6

Pick up point The International Hotel

Drop off point 7

We provide some things in the car to help you. Your sales representative will go through all the things that you will find in your glove compartment and boot. Different cars have different things provided.

In case of 8 or, call our emergency number 06387 638 972 to order a replacement car.

Questions 9-10

Instructions to follow

- Choose and circle TWO letters A – J.

Which TWO items are NOT provided in Mr. Wilson's hire car?

- A insurance documents
- B Westley town map
- C the car manual



- D a larger area map of the local district
- E a map of London
- F a spare wheel
- G a set of tools
- H RAC membership card
- I a small fire extinguisher
- J spare keys for the car

9 _____

- A B C D E F G H I J

10 _____

- A B C D E F G H I J



Part 2

Questions 11-16

Instructions to follow

- Complete the notes below.
- Write NO MORE THAN TWO WORDS AND/OR A NUMBER for each answer.

Barker’s Country Safaris!

Established:¹¹..... years ago by John and Nancy Barker.

As teens the Barkers enjoyed:

climbing , kayaking, white-water rafting, pot-holing

.....¹².....

At University they organized:

motor trips

.....¹³..... tours

5 years ago they.....¹⁴..... their regular jobs

.....¹⁵..... years later they began running activity tours

1 year ago started activities for¹⁶..... groups



Questions 17-20

Instructions to follow

- Complete the table below.
- Write NO MORE THAN TWO WORDS OR A NUMBER for each answer.

Tour Options

Name	Size	Times
Woodland tour and trail	10 jeeps ¹⁷ people per jeep	Morning: 8 am Afternoon: ¹⁸ pm to 6 pm Evening: 7-11 pm
Family ¹⁹	1 jeep/jeeps if ²⁰ party	Whole Day From 10 am till 11 pm



Part 3

Questions 21-23

Instructions to follow

- Choose THREE letters A-G.

According to the discussion, which THREE reasons are given for dividing up tasks in a group?

- A people can do whatever they want
- B the lecture notes suggested it
- C the work will be distributed evenly
- D a classmate suggested it
- E some tasks take longer
- F most groups do it this way
- G some tasks are more difficult than others

21 _____

- A B C D E F G

22 _____

- A B C D E F G

23 _____

- A B C D E F G



Questions 24-26

Instructions to follow

- Complete the table below
- Write NO MORE THAN TWO WORDS for each answer.

Schedule Of Tasks		
Person responsible	Tasks	Due date
Tom	Design the survey	March 23
Anne	_____ ²⁴ _____	Mid-march
Carol	_____ ²⁵ _____ the survey	_____ ²⁶ _____ late march

Questions 27-30

Instructions to follow

- Complete the notes below.
- Write NO MORE THAN TWO WORDS AND OR A NUMBER for each answer.

Guidelines for oral presentation

Due date: April 12

Length: ²⁷ _____ Minutes max _____ minutes

Points for delivery: maintain ²⁸ _____



- don't read the presentation
- speak clearly

Make use of gestures

Include a variety of 29

- OUTs
- Handouts
- use the 30
- DVD or video





Part 4

Questions 31-35

Instructions to follow

- Complete the table below.
- Write NO MORE THAN TWO WORDS for each answer.

Name of Area	Location of Area	Purpose of Area
Decompression zone (sometimes called the ³¹ zone)	situated immediately inside the entrance and is generally free of ³²	to encourage the customer to ³³ to the supermarket
..... ³⁴ zone	situated on the right side near the front door	to relax before they start shopping
power aisle	the central route through the supermarket	to display ³⁵



Questions 36-40

Which items do the following sentences apply to?

- A fruit and vegetables
- B bread and milk
- C cheap tinned foods
- D flowers
- E sunglasses

36 They are referred to as distress goods.

- A B C D E

37 They are always located at the front of the supermarket.

- A B C D E

38 They are referred to as destination goods.

- A B C D E

39 They are normally located below eye level.

- A B C D E

40 They are often located at the check-out.

- A B C D E



Practice Test 5

Instructions to follow

Listen to the [audio](#) and answer the questions below

Part 1

Questions 1-3

Instructions to follow

- Complete the notes below.
- Write NO MORE THAN TWO WORDS AND/OR A NUMBER for each answer

Customer called about **television** repairs

Customer's name: Mrs 1

Address: 135 park 2 Sommerton

Phone: 3

Questions 4-7

Instructions to follow

- Answer the questions below.
- Write NO MORE THAN TWO WORDS AND/OR A NUMBER for each answer.

- 4 What is the problem with the TV ? _____
- 5 What may have caused the problem ? a _____
- 6 What is the TV make and model number? _____





7 How old is the TV ? _____ old

Questions 8-10

Instructions to follow

- Choose the correct letters, A, B or C.

8 Where is the customer's house?

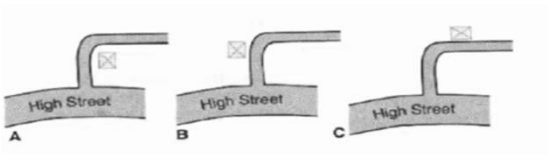

- A High street
- B High street
- C High street

9 When will the electrician call at the house?

- A Friday afternoon
- B Saturday morning
- A Monday morning

10 Now did the customer first hear about the repair service?

- A from a neighbour
- B from the phone book
- A from the Internet



Part 2

Questions 11-16

Instructions to follow

- Choose the correct letter, **A**, **B**, or **C**.

11 What is the purpose of the talk?

- A to welcome its new members
- B to commemorate its 10th anniversary
- C to celebrate the award it received recently

12 What's the audience of this speech?

- A journalists
- B local residents
- C school children

13 Why is the speaker most proud of the skating rink?

- A Because two world champions have been trained there.
- B Because people in this area are fitter than the rest of the country.
- A Because they have encouraged local school children to participate more in sports.

14 The complex has recently opened a new venue for

- A the unemployed.
- B mothers with babies.
- A pensioners



- 15 What does the complex plan to do next year?
- A extend opening hours
 B expand the space
 C sell fitness equipment
- 16 What does the complex encourage people to do?
- A become a coach
 B be on the committee
 C work as volunteers

Questions 17-20

Instructions to follow

- Choose **FOUR** answers from the box and write the correct letter, **A-G**, next to Questions 17-20.

Features

- A A one-on-one coach is bookable.
 B It is featured in a TV drama.
 C It is beneficial for young people.
 D It is only available for women sometimes.
 E It is the largest in the country.
 F It can be booked for parties.
 G It is a place to hold courses for school children.



Sports facilities

17 Swimming pool

- A B C D E F G

18 Climbing wall

- A B C D E F G

19 Skating rink

- A B C D E F G

20 Gym

- A B C D E F G





Part 3

Questions 21-26

Instructions to follow

- Complete Judith's notes below.
- Write **NO MORE THAN TWO WORDS** for each answer.

NORTH SEA OIL AND GAS INDUSTRY BACKGROUND

- North Sea oil and gas exploration was initially rejected but has now really expanded during²¹.....years.
- First significant quantities of gas first discovered in Groningen area off The Netherlands in 1959.
- First British discovery of same in West Sole field, off the coast of East Anglia, by²².....in 1965.
- British oil and gas industry experienced rapid growth in the early years.
- An²³.....in the UK led to enormous pressure to increase production of North Sea gas and oil.
- Oil field discoveries increased with British, European and American firms buying North Sea exploration²⁴.....
- In 1990s the oil business suffered due to²⁵.....of oil.
- Production grew and peaked around 2000/1.
- North Sea is currently looked upon as a²⁶.....on a slow decline.



Questions 27-30

Instructions to follow

- Complete the summary of Fred’s talk below.
- Write **NO MORE THAN TWO WORDS** for each answer.

NORTH SEA OIL AND GAS INDUSTRY SAFETY INFORMATION

Although the Sea Gem was the first North Sea oil exploration accident, the most well known accident was aboard the Piper Alpha platform in 1988 when 13 people died. Because of these and other accidents, platforms now have rigorous safety procedures, for example:

- Installation Safety Tour showing all safety aspects eg: –²⁷.....
- emergency muster stations²⁸.....
- emergency procedures
- Rig Safety Programme Introduction
- Weekly Safety Meetings
- Daily Pre “Tour” Meetings
- Inter Company Safety Information Scheme
- Fire and Boat Practice with²⁹.....
- Mock Abandon the Rig Exercise

Statistics now show that these measures have succeeded and that workers are more likely to be killed on³⁰.....



Part 4

Questions 31-40

Instructions to follow

- Complete the notes below. Write ONE WORD ONLY for each answer.

Arguments For And Against Urban Migration

Cities now:

- account for 3% of the planet's land areas
- consume more³¹..... than the countryside

Advantages for moving into the city:

- good for some³²..... to recover
- poor³³..... in the countryside
- clean energy: recycling of methane gas produced from³⁴.....

For women:

- more likely to have late marriages
- better chance of getting a³⁵..... at work

Downsides of moving into the city:

- possible to lose³⁶..... because it is difficult to maintain previous lifestyle
- higher rates of³⁷..... in the city than in the country
- poor quality of³⁸..... in the city

Economic factors:

- Increased³⁹..... in population results in increase in energy consumption.
- People find the heavy⁴⁰..... stressful.



Practice Test 6

Instructions to follow

- Listen to the [audio](#) and answer the questions below.

Part 1

Questions 1-6

Instructions to follow

- Complete the notes below. Write ONE WORD ONLY for each answer.



1 First, students should pay more attention to the relationship with their _____.

2 Students should meet their tutor _____.

3 Add a "to do" list for students themselves and the tutor, including a reading _____.

Students should _____ 4 _____ with their tutor, if they disagree with their advisor, they must

state their _____ 5 _____ and _____ 6 _____ clearly and calmly.



Questions 7 - 10

Instructions to follow

- Look at the checklist below. Select A-G and answer questions 7-10.

The principles for the students about getting the most out of what they read

- A be organised
- B keep your "to do" list
- C be efficient
- D write the time and date of next meeting
- E summarise what you have read
- F minimise your other commitments
- G read PhD theses

7 _____

- A B C D E F G

8 _____

- A B C D E F G

9 _____

- A B C D E F G

10 _____

- A B C D E F G



Part 2

Questions 11-14

Instructions to follow

- Complete the information below.
- Write NO MORE THAN TWO WORDS for each answer.

The National Union of Students will run a National _____¹¹_____ next month. Every student should _____¹²_____ some time to help the community. This is a nationwide scheme. It has two aims: to show the public that students are _____¹³_____ members of society, to show students can give their _____¹⁴_____ help to their community.

Questions 15-17

Instructions to follow

- Write NO MORE THAN TWO WORDS for each answer. Fill in the gaps below.

The old man's name is _____¹⁵_____.

Address 8 Milkman _____¹⁶_____.

Students' job paint _____¹⁷_____.



Questions 18-20

Instructions to follow

- Indicate whether the following statements are accurate or not by writing

- A for an accurate statement
- B for an inaccurate statement
- C if there is insufficient information

18 The old lady never went out to work.

- A B C

19 The old lady's husband once served in the Army.

- A B C

20 The girl student also liked the book very much.

- A B C



Part 3

Questions 21-24

Instructions to follow

- Complete the form below.
- Write **NO MORE THAN THREE WORDS** or **A NUMBER** for each answer.

Conference Registration Form

Name of Conference: Beyond 2000

Name: Melanie Ms _____ ²¹

Address: Room _____ ²² at Women's College Newtown

Faculty: _____ ²³

Student No: 24 _____ ²⁴

Questions 25-30

Instructions to follow

- Circle the correct letters **A-C**.

²⁵ Registration for:

- A Half day
- B Full day
- A Full conference

²⁶ Accommodation required:



- A Share room/share bathroom
- B Own room/share bathroom
- A Own room with bathroom

27 Meals required:

- A Breakfast
- B Lunch
- C Dinner

28 Friday SIGs:

- A Computers in Education
- B Teaching Reading
- C The Gifted Child

29 Saturday SIGs:

- A Cultural Differences
- B Music in the Curriculum
- A Gender Issues

30 Method of payment:

- A Credit Card
- B Cheque
- A Cash



Part 4

Questions 31-40

Instructions to follow

- Answer the questions below.
- Write NO MORE THAN TWO WORDS OR A NUMBER for each answer.

- 31 In which decade did the British Council create the EPTB exam?
- 32 What did the 'B' of 'EPTB' stand for?
- 33 In which year was ELTS introduced?
- 34 What kind of language 'context' was ELTS intended to reflect?
- 35 How many candidates took ELTS in 1985?
- 36 What was conducted in 1987?
- 37 Of what were there 210 in 1995?
- 38 Which IELTS module was revised in 2001?
- 39 In which year was a computerised version of the exam introduced?
- 40 How does the lecturer describe the 'industry of English-language exams'?



Practice Test 7

Instructions to follow

- Listen to the [audio](#) and answer the questions below

Part 1

Question 1-4

Instructions to follow

- Complete the notes below.
- Write **NO MORE THAN TWO WORDS AND/OR A NUMBER** for each answer.

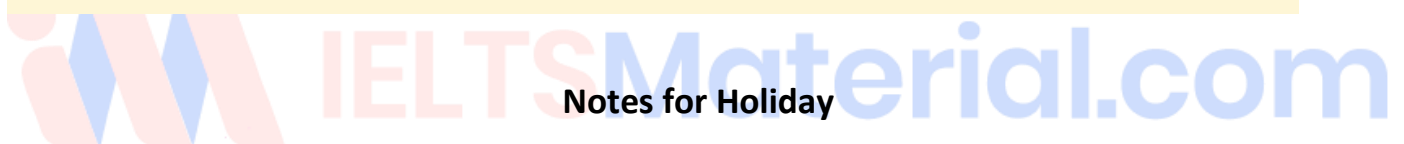
Notes for Holiday

Travel Information

- Must find out which **1** arriving at.
- Best Taxi company **2**
- Note: Simon lives in the **3** of the city
- Simon's cell phone number: **4**

Questions 5 - 10

Instructions to follow

- Complete the notes below.
- Write **NO MORE THAN TWO WORDS AND/OR A NUMBER** for each answer.



What to pack

To wear:

- casual clothes

one smart dress to wear at a 5.

- a good 6

-tough 7.

To read:

- try to find book named 8 by Rex Campbell

For Presents:

- For Janice: 9.

- For Alec: 10.

(with racing pictures)



Part 2

Questions 11-14

Instructions to follow

- Complete the form below.
- Write NO MORE THAN THREE WORDS AND/OR A NUMBER for each answer.

DVD Customer Profile

Occupation: student (For example)

Have you owned a DVD player before? No

What is the maximum you want to spend on a DVD player? _____ **11** _____

How often do you watch DVDs? _____ **12** _____

What type of films do you enjoy? _____ **13** _____

What other DVDs (non-film) do you watch? _____ **14** _____

Questions 15-20

Instructions to follow

- Complete the table below.
- Write NO MORE THAN TWO WORDS AND/OR A NUMBER for each answer



Player	Features	Cost	After-sales service
DB 30	basic	£69	_____ 15 _____ only
XL 643	Can also _____ 16 _____	_____ 17 _____	_____ 18 _____ at reduced cost
TriX 24	Will also play _____ 19 _____	£94 including _____ 20 _____	Guaranteed for 3 years





Part 3

Questions 21-26

Instructions to follow

- Complete the table showing the student's opinion
- Choose your answers from the box below
- There are more words than spaces so you will not use them all.
- You may use any of the words more than once.

Student	Favourite Instrument	Favourite style of music
Greg 21		
Alexandria 22		
Katja 23		
Rachel 24		
Harry 25		
Emika 26		

Instrument

Guitar Violin Pipa

Organ Piano Bouzouki

Piano Drums Harp

**Style of Music**

Ballet music Rap Classical

Heavy metal Opera Jazz

Rock Be-Bop Country

Questions 27-30**Instructions to follow**

- Complete the form below. Write NO MORE THAN TWO WORDS for each answer.

- 27 Stimulating music speeds up our _____
- 28 Calming music reduces our _____.
- 29 _____ music has very predictable rhythms.
- 30 Research may show if people of different _____ perceive music differently.



Part 4

Questions 31-33

Instructions to follow

- Choose the correct answer, A, B or C.

31 'Extremophiles' are life forms that can live in

- A isolated areas.
- B hostile conditions.
- A new habitats.

32 The researchers think that some of the organisms they found in Antarctica are

- A new species.
- B ancient colonies.
- A types of insects.

33 The researchers were the first people to find life forms in Antarctica

- A in the soil.
- B under the rock surface.
- A on the rocks.



Questions 34-40

Instructions to follow

- Complete the sentences below. Write ONE WORD ONLY for each answer.

How the extremophiles survive?

- 34 Access to the sun's heat can create a _____ for some organisms.
- 35 The deeper the soil, the higher the _____ of salt.
- 36 Salt can protect organisms against the effects of _____ even at very low temperatures.
- 37 All living things must have access to _____ water.
- 38 Salt plays a part in the process of _____ which prevents freezing.
- 39 The environment of _____ is similar to the dry valleys of Antarctica.
- 40 This research may provide evidence of the existence of extra terrestrial life forms and their possible _____ on other planets.



Practice Test 8

Instructions to follow

- Listen to the [audio](#) and answer the questions below

Part 1

Question 1-2

Instructions to follow

- Complete the sentences with the correct answer from the list.

1 The students are planning to study

- A different types of celebration.
- B how the festivals started.
- A people's attitudes to festivals.

2 The students have already discovered

- A the seasons in different countries.
- B how the Carnival is linked to different times of the year.
- A similarities between countries that are far away from each other.



Question 3-5

Instructions to follow

- Choose THREE letters A-G.

What do the students say about the changes in the Carnival since it started ?

- A It has turned into a church celebration.
- B It celebrates the end of winter.
- C It is only celebrated in Europe.
- D It is celebrated in many different regions.
- E It takes place during the rainy season.
- F It is not connected with the seasons.
- G It is celebrated when the weather is very hot.

3 what _____

- A B C D E F G

4 where _____

- A B C D E F G

5 when _____

- A B C D E F G



Question 6-10

Instructions to follow

- Write NO MORE THAN TWO WORDS for each answer.

6 What else are the students going to research? _____

7 How many countries do they know of where festivals involve water?

8 What three meanings can water have? Life- wealth - _____

9 What do water festivals celebrate?

10 How are the carnival and the seasons linked by? _____



Part 2

Question 11-14

Instructions to follow

- Complete the table below.
- Write NO MORE THAN TWO WORDS OR A NUMBER for each answer.

University Clubs and Societies

Club	Membership fee	Number of members
_____ 11 _____	*20	60
Cross country cycling	*15	_____ 12 _____
Film and drama	*50	_____ 13 _____
_____ 14 _____	*5	80

Question 15-17

Instructions to follow

- Choose THREE letters A - G.

Which THREE activities does Victoria enjoy?



- A contemporary dance
- B yoga
- C film and drama
- D cycling
- E photography
- F running
- G jazz and tap dancing

15 _____.

- A B C D E F G

16 _____.

- A B C D E F G

17 _____.

- A B C D E F G

Question 18-20

Instructions to follow

- Complete the form below.
- Write NO MORE THAN TWO WORDS AND/ OR A NUMBER for each answer.

Name: Victoria _____ 18 _____



Age: 19

Address: 57, 19 Atherton Park, MANCHESTER M46

Contact number: 20 & Email: victoriainatherton@england.com





Part 3

Question 21-25

Instructions to follow

- Choose the correct letter A, B or C.

21 Why are they going to the main hall?

- A to apply for a course
B to hand out some forms
C to register for the coming year

22 Where is the Administration Office?

- A on ground level
B on the first floor
C on the second floor

23 What do they agree to do?

- A to separate and meet later
B to go to the Main Hall together
A to go to the Canteen together



24 What does Phoebe want to drink?

- A coke
- B orange juice
- C water

25 How much money does Phoebe give Mike?

- A twenty pounds
- B five pounds
- C two pounds

Question 26-28

Instructions to follow

- Complete the form below.
- Write NO MORE THAN TWO WORDS for each answer.

Name of student:²⁶.....

Town:²⁷.....

Course:



First year 28

Question 29-30

Instructions to follow

- Choose the correct letter A,B, or C.

29 What did Mike buy her to eat ?

- A a chicken and tomato sandwich
- B a ham and cheese sandwich
- A a cheese and tomato sandwich

30 What must the students do as part of registration at the university ?

- A pay their fees
- B find out about lectures
- A check the noticeboard



Part 4

Question 31-40

Instructions to follow

- Complete the form below.
- Write NO MORE THAN TWO WORDS AND/ OR A NUMBER for each answer.

A Pirate’s Story: William Kidd

William Kidd lived in the³¹..... and gained widespread notoriety as a pirate because his exploits were documented in³².....
 People still search to this day for his³³.....

Timeline of William Kidd’s life

- 1680’s Early years at sea
- Was Known as a legitimate³⁴..... and sea captain.
- Battled against the French.
- Owned property in³⁵.....
- 1695 Hired to capture³⁶.....
- 1697 Converted to³⁷.....
- Murdered his gunner, William Moore, after a mutiny attempt.
- 1698 Abandoned former ship to commandeer greatest prize, the “Quedagh Merchant”



1701 After trying to prove his innocence, found guilty and³⁸.....

Questions about Kidd's life

Later questioning caused some to believe that there was not enough³⁹..... to declare Kidd guilty

Some of his treasure were still found and given to⁴⁰.....





Practice Test 9

Instructions to follow
 Listen to the [audio](#) and answer the questions below

Part 1

Question 1-7

Instructions to follow

- Complete the form below.
- Write NO MORE THAN TWO WORDS AND/ OR A NUMBER for each answer.

Number of nights _____ **1** _____

Type of rooms: Single/Double - twin beds/ Double - king - sized bed

Name _____ **2** _____

Home address _____ **3** _____ Avenue

Postcode _____ **4** _____

Transport _____ **5** _____





Meals _____ **6** _____

Date of arrival _____ **7** _____ 16th April.

Questions 8 - 10

Instructions to follow

- Choose the correct letter, A, B, or C.

8 The customer's mobile phone number is:

- A 07976 122577
 B 07961 122577
 C 07961 121597

9 The customer would also like to:

- A receive tourist information
 B make a restaurant booking
 A book tickets for the theatre

10 He leaves a message for:

- A Mr. Alami



- B Mr. El Fassi
- A Mr. Alaoui





Part 2

Questions 11-14

Instructions to follow

- Complete the summary below.
- Write ONE WORD ONLY for each answer.

DEVELOPMENT @!

To many employers, academic success and personal development as a result of being at¹¹..... can be as important as course content. So choose¹²..... modules that you may do well in. you should, however, think more carefully about your choice if your course is¹³..... In this case the course normally includes all the modules necessary for professional training, but if you are in any doubt check with your academic department or the¹⁴..... at the university.

Questions 15-19

Instructions to follow

- Write Appropriate letters, A-C against questions 15 - 19.

Which modules have the following features?

- A Applied Chemical Engineering
- B Fluid Mechanics



C Chemical Engineering: Science 1

15 developing computer skills

- A B C

16 exemption from part of a module

- A B C

17 assessment by formal examination

- A B C

18 developing speaking and writing skills

- A B C

19 learning through problem solving

- A B C

Questions 20

Instructions to follow

- Choose the correct letter A, B, or C.

Which chart shows the percentage of private study time on the Spanish 1A Module?

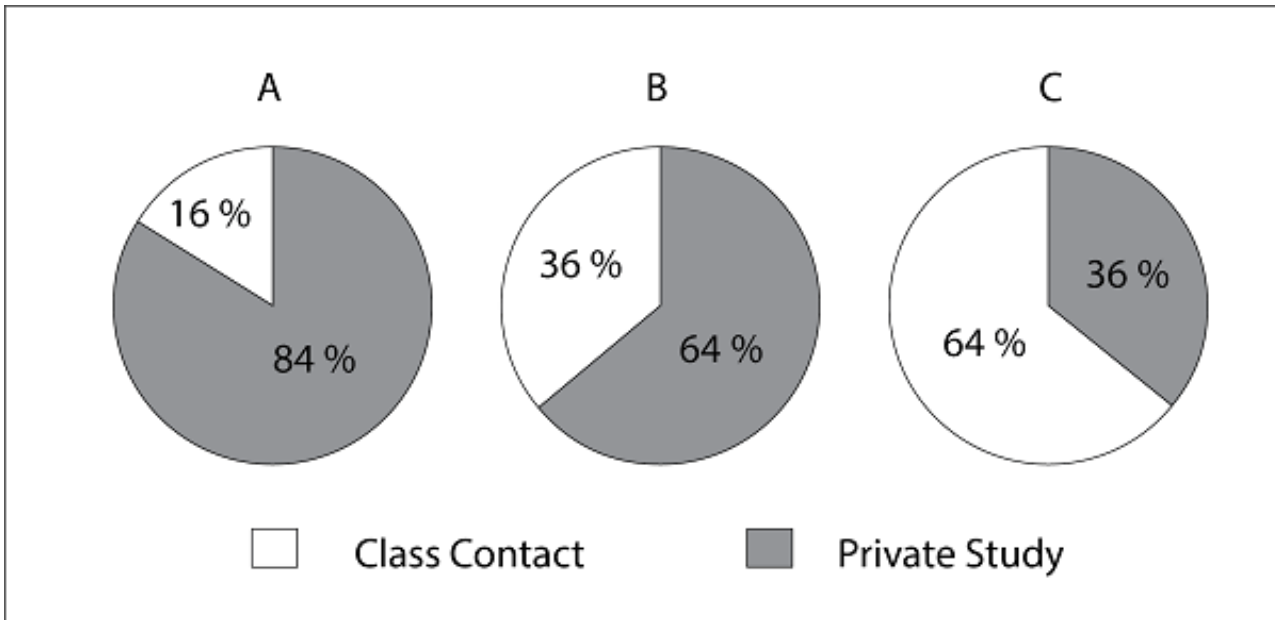

20





Part 3

Questions 21-25

Instructions to follow

- Complete the flowchart below. Write NO MORE THAN TWO WORDS for each answer.

Doxey's Irridex model of tourism

Euphoria

- Tourists seen as a²¹..... and welcomed
- Tourism could bring chance of²².....

Apathy

- Interest becomes sectionalized
- Contacts tend to be²³.....

Annoyance

- Problems caused by overdevelopment and²⁴.....
- Policy makers attempt solutions by increasing infrastructure

Antagonism

- Open hostility to tourists
- Tourists blamed for change to²⁵.....



Questions 26-30

Instructions to follow

- Complete the summary below
- Write NO MORE THAN TWO WORDS for each answer.

Criticism of Doxey's model

The model has been criticized as giving a²⁶..... view of the effects of tourism, because it is unidirectional.

It is also rather oversimplified-in fact²⁷..... are more complex and varied.

Positive effects of tourism

Tourism may give tourists increased understanding of other societies and cultures, and in the host community it may lead to the revitalization of²⁸.....

Tourism may also help groups and individuals by creating new jobs for²⁹..... and by encouraging people who work in tourism to learn³⁰.....



Part 4

Questions 31-40

Instructions to follow

- Complete the notes below. Write NO MORE THAN TWO WORD/ OR A NUMBER for each answer.

RECOMMENDED BANKS

Barclays

National Westminster

HSBC

Halifax

LOCATION

Ragdale Square

Preston 31

City Plaza

..... 32

International students must provide 33 proving they can support themselves.

International students must take with them a photocopy of their passport and 34 of their enrolment.

Time given by universities for the repayment of loans is limited 35

The university has an interest rate of 36

Recommended accounts are either a 37 account or a 38 account.

Automatic teller machines allow you to make 39 at any time.

Maestro services 40 take the money from your account.



Practice Test 10

Instructions to follow

-  Listen to the [audio](#) and answer the questions below

Part 1

Questions 1-2

Instructions to follow

- Choose the correct letter A, B C or D.

1 Where do they plan to travel?

- A the coast
B the mountains
A Sydney
D the desert

2 Where do they plan to stay during the holiday?

- A a motel
B a hotel
C a youth hostel
D a holiday house



Questions 3

Instructions to follow

- Choose **THREE** letters A-F.

3 What will they take with them?

A B C D E F

- A mosquito net
- B insect repellent
- C thick coats
- D medicines
- E binoculars
- F camera



Questions 4-5

Instructions to follow

- Choose the correct letter A-D or A-C.

4 How much money do they need for the tour?

- A \$480
- B \$490
- A \$500
- D \$300

5 How will they pay the house fee?

- A with the traveler's cheque
- B with the credit card
- C with the saving card

Questions 6 - 10

Instructions to follow

- Answer the following questions with **NO MORE THAN TWO WORDS** for each answer.

When will they depart for the holiday?

6 _____

Where is the place they are going to stay located?

Opposite **7** _____



Why do many tourists go to this place?

Do **8** _____

Which **TWO** things in the bushes should they be careful about?

9 _____

10 _____





Part 2

Questions 11-15

Instructions to follow

- Label the diagram below.
- Write **NO MORE THAN TWO WORDS** for each answer.

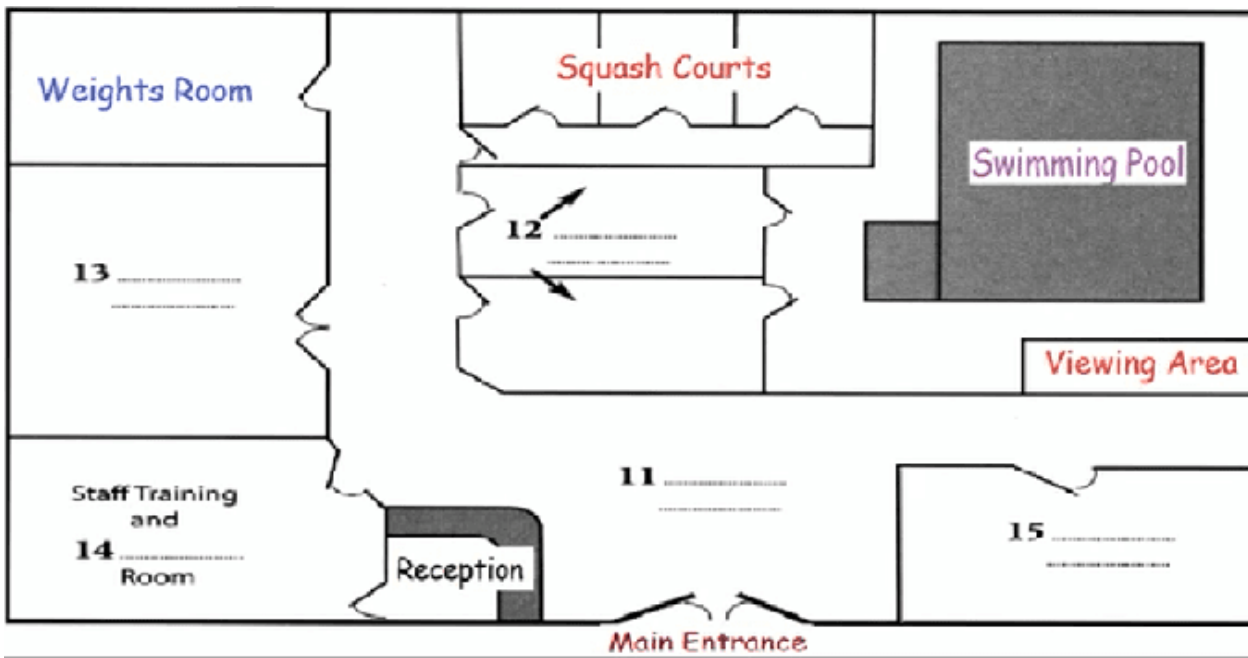

- 11 _____
- 12 _____
- 13 _____
- 14 _____
- 15 _____



Questions 16-20

Instructions to follow

- Complete the table below.
- Write **NO MORE THAN TWO WORDS AND/OR A NUMBER** for each answer.

Membership Type	Cost	Access	Additional Benefits
Anytime ¹⁶	Any time between 5 a.m. and midnight	Access to ¹⁷ clubs nationwide.
Free time	£500	Between 10 a.m. and 3 p.m.	Access to ¹⁸
Standard	£400	Same as Free time but only ¹⁹	None



Children ²⁰ discount	Depends on choice of scheme	Depends on choice of scheme
----------	---------------------------------------	--------------------------------	--------------------------------





Part 3

Questions 21-23

Instructions to follow

- Complete the sentences below. Write **NO MORE THAN THREE WORDS** for each answer.

- 21 The best days for engineering students are
- 22 Students can get useful suggestions about
- 23 Use the internet to look atbefore the event.

Questions 24-27

Instructions to follow

- Choose the correct letter A, B or C.

- 24 Fergus says that
- A there is one company he is particularly interested in
 - B he has done some research already
 - A he knows the boss at one of the companies
- 25 The tutor thinks Fergus should
- A prepare questions in advance
 - B research the skills required for jobs before the event
 - C find out what the starting salaries are
- 26 Fergus plans



- A to wear a suit and tie
- B to wear smart but casual clothes
- C to buy an outfit for the event

27 The tutor suggests that Fergus

- A should ask particular people certain questions
- B should avoid taking free gifts
- C should treat conversations like short interviews

Questions 28-30

Instructions to follow

- Choose **THREE** letters A-F.

Why do the tutor and Fergus think it is useful to attend a jobs fair?

- A to get a job
- B to find out what employers want from you
- C to give employers your contact details
- D to discover which are the key companies to work for
- E to practice your communication skills
- F to make useful contacts

28 _____

- A B C D E F

29 _____



- A
- B
- C
- D
- E
- F

30 _____

- A
- B
- C
- D
- E
- F





Part 4

Questions 31-40

Instructions to follow

- Complete the notes below.
- Write NO MORE THAN TWO WORDS for each answer.

Eco-tourism

Aims:

- To encourage tourists to travel in a responsible way
- To reduce the³¹..... of tourism (for example, rubbish,³²..... and criminal activity).

Alternative Tourism

- Is different from traditional holidays (for example, beach and sightseeing holidays)
- Examples :.....³³..... and adventure trips

Sustainable Tourism

- Shares the same.....³⁴..... as eco-tourism
- Travel is not restricted to.....³⁵..... (can include travel to urban areas too)
- Involves adhering to local³⁶..... (for example, dress and language)



Volunteerism

- Combines volunteering with tourism
- Involves assisting with building work in local communities and participating in³⁷.....
- Examples : Tree planting in Costa Rica
- Assistance with sustainable³⁸..... in Cuba
- Cleaning up local³⁹..... in Jamaica
- Animal conservation in.....⁴⁰..... and Ecuador





Practice Test 11

Instructions to follow

- Listen to the [audio](#) and answer the questions below

Part 1

Questions 1-10

Question 1-4

Instructions to follow

- Complete the notes below. Write **NO MORE THAN TWO WORDS AND/OR A NUMBER** for each answer.

ITALIA BREAKS

Example

Destination: **Venice**

Name: John 1

Mobile number: 07987 2



Number of people: Two adults

Holiday length: 3

Hotel Scotland: 4 star

Question 5-6

Instructions to follow

Choose **TWO** letters **A–E**. Which **TWO** good things about Hotel Scotland are mentioned?

A restaurant	B convenience	C room with a terrace
D large rooms	E cleanliness	

5 _____

- A
 B
 C
 D
 E

6 _____

- A
 B
 C
 D
 E



Question 7-10

Instructions to follow

- Write **NO MORE THAN THREE WORDS AND/OR A NUMBER** for each answer.

- 7 The departure date is _____
- 8 The holiday excluding insurance costs £ _____
- 9 The discount is _____ per cent if booked before 17th February.
- 10 The booking reference is _____





Part 2

Question 11-15

Instructions to follow

- Complete the following table below.
- Write NO MORE THAN TWO WORDS for each answer.

How to safeguard your home		
	Do's	Don'ts
How to secure the window	Leave _____ 11 _____ device to your windows	
	Use a _____ 12 _____ device for your windows	
How to secure the door	Install a YOU _____ 13 _____ in front of the door	Open the door to anyone _____ 14 _____
	Prepare a stepping ladder or stepping box for the kids	
How to secure your valuables		Leave them where they can be seen from the _____ 15 _____
	Make a valuables _____ 16 _____	
	Engrave your valuables	



Question 17-18

Instructions to follow

- Circle the appropriate letter, A - C.

17 To ensure safety in your courtyard, you should install aight _____.

- A Near the door
- B Near each of your windows
- A Somewhere high out of reach

18 Why is there a need to trim hedges or bushes in your courtyard

- A Because they may be used by burglars as good hiding places
- B Because they do not help in creating an occupancy illusion
- A Because they may block the views from the windows or peepholes.



Question 19-20

Instructions to follow

- Complete the notes below.
- Write NO MORE THAN TWO WORDS for each answer.

Strategies when you're on a vacation

- Buy electronic timers that turn lights on and off at different times
- Have your mail delivery and newspaper _____ 19 _____.
- Ask a neighbor to park in your driveway or parking place



- Think about having someone house sit your home
- Leave your shades as they're normally.
- Lock your _____ **20** _____ with a padlock





Part 3

Questions 21-25

Instructions to follow

- Complete the sentences below. Use **NO MORE THAN TWO WORDS**.

According to Mike:

- 21 Condors will be reestablished in their former
- 22 The last condors died out in Baja in the
- 23 The area is preferred because it is very with not many people.
- 24 Four to eight birds will be every year.
- 25 The number of birds an area can hold is called its

Questions 26-27

Instructions to follow

- Complete the table. Use **NO MORE THAN TWO WORDS**.

Programme Goal



Within 10 years

Condors flying 26

Within 27 years 150 birds

Questions 28-30

Instructions to follow

- Which THREE advantages of satellite transmitters does Mike mention? Circle the three correct letters.

List of Advantages

- A Follow condor fast enough
- B Not bother people living nearby
- C Cheaper than other alternatives
- D Monitor where planes can't
- E Keep you off dangerous roads
- F Gage effectiveness of reintroduction

28 _____

- A B C D E F



29 _____

- A B C D E F

30 _____

- A B C D E F





Part 4

Questions 31-37

Instructions to follow

- Choose the correct letter A, B, or C.

31 The purpose of the data collection was to

- A test people's reaction to different buildings.
- B collect detailed information on various buildings.
- C the beauty of different public buildings.

32 The initial plan to use a questionnaire was abandoned, because

- A it would take too much time to produce.
- B the questions were too difficult to write.
- A it would take too long for people to complete.

33 People indicated their reactions on a 1—5 scale,

- A giving rise to some interesting answers.
- B ensuring that the information was easier to collect
- A making it quicker to choose the top three images.

34 To make sure people could see the detail in the images better

- A only daylight images were used.
- B black and white images were used.
- C the images were produced in color.



35 What was done to preserve the images when being used?

- A they were covered in plastic with a special machine.
- B people were asked to wear gloves when touching them
- C the images were handled only by the researcher.

36 Among the people Who formed part of the sample were

- A tourists from various places.
- B office workers during lunch-break.
- A Commuters as they exited stations.

37 What was the reasons appointing a leader for the group?

- A to comply with the instructions for the task.
- B to help hold the team together.
- A to allocate tasks to the various members.

Questions 38-40

Instructions to follow

- which findings match the age groups of the image testing?
- Write the appropriate letter next to each age group.

Findings

- A varied reaction
- B mainly scored 1



C mostly scored 3

D mainly scored 5

38 11—18 year-olds

A B C D

39 20-40 year-olds

A B C D

40 50years Old and over 1s=45.....

A B C D





Practice Test 12

Instructions to follow

-  Listen to the [audio](#) and answer the questions below

Part 1

Questions 1-6

Instructions to follow

- Choose the correct letter, A, B or C.

1 Becoming a Friend of Laverton Arts Centre

- A costs £15.
B costs £50.
A doesn't cost anything.

2 How many newsletters do Friends receive each year?

- A four
B one
A three

3 Friends of the Arts Centre can buy

- A more tickets than other visitors
B tickets before other visitors.



books earlier than other visitors

4 There might be reductions on tickets for events

in the Small Theatre.

in the Main Theatre.

at the Arts Cinema.

5 The Arts Centre is changing

the password for its website.

its website address.

the design of its website.

6 Friends of Laverton Arts Centre are

required to attend a certain number of events.

not forced to attend a certain number of events.

encouraged to count how many events they attend.

Questions 7-10

Instructions to follow

- Complete the sentences below.
- Write NO MORE THAN TWO WORDS AND/OR A NUMBER for each answer.

7 The woman has visited the Arts Centre times _____ in total.

8 The first event at the Arts Centre the woman went to was _____

9 The woman was unaware that there was _____ at the Arts Centre.



10 The woman likes the idea of _____.





Part 2

Questions 11-20

Question 11-13

Instructions to follow

- fill in the details to complete the information on the map below.



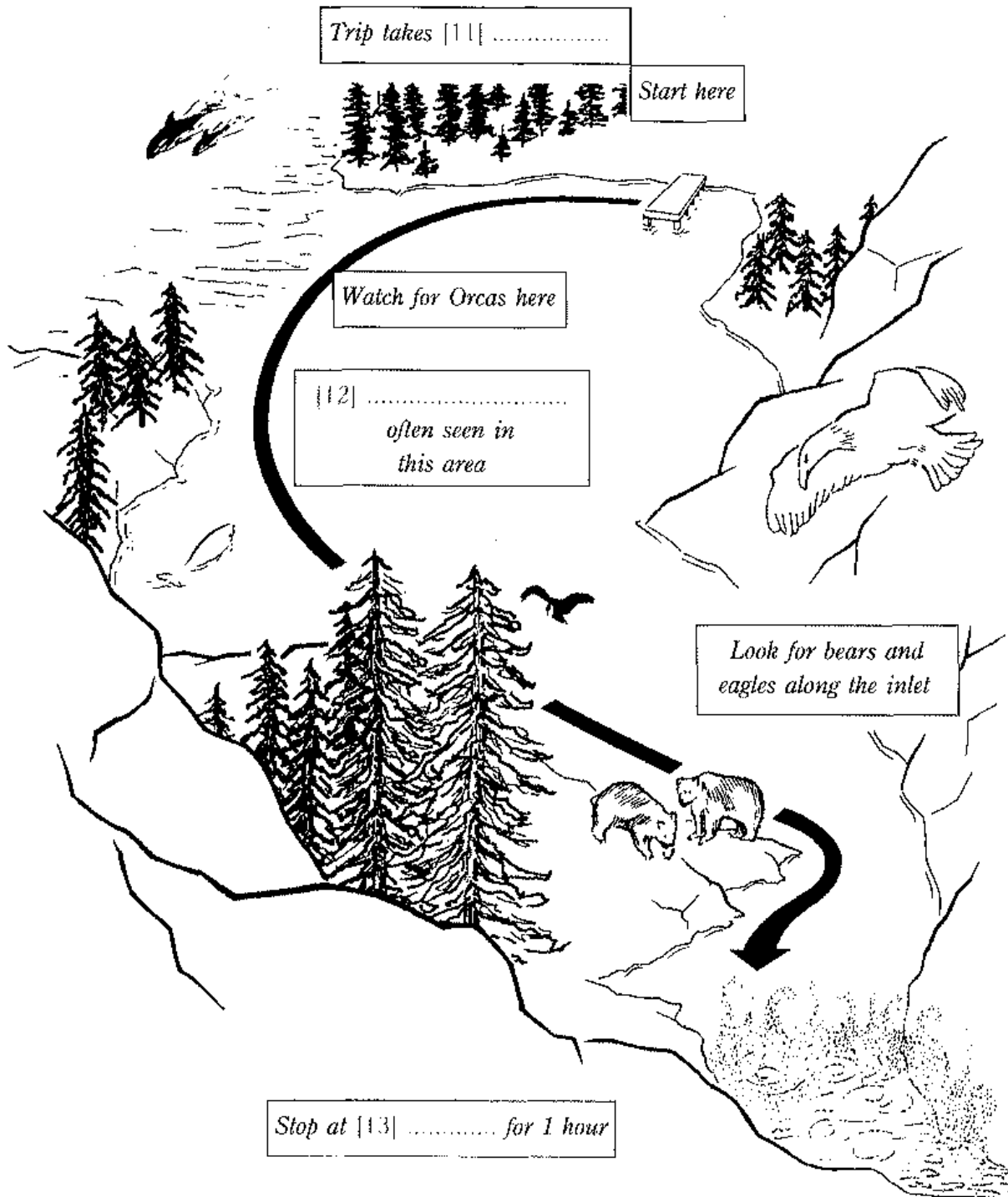



11 _____

12 _____

13 _____

Question 14-16

Instructions to follow

- Fill in the chart using NO MORE THAN TWO WORDS or a NUMBER for each answer.

Whale Identification Chart			
	Colour	Size	General Characteristics
Dolphins	grey	1-2 metres	_____ 14 _____



<p>Orcas/ Killer Whales</p>	<p>_____ 15 _____</p>	<p>7 - 8 metres</p>	<ul style="list-style-type: none"> • fierce hunters • eat fish, seals, other whales
<p>Grey Whales</p>	<p>Grey</p>	<p>_____ 16 _____</p>	<ul style="list-style-type: none"> • migratory • solitary • filter feeders, eat shrimp

Question 17-20

Instructions to follow

- Complete the following using **NO MORE THAN TWO WORDS**.

- For a smooth ride, sit in _____ **17** _____ of the boat.
- Watch the waves and hold onto the ropes.



- Survival suits are _____ **18** _____ in colour for maximum visibility. They are designed to keep you floating upright in the water even if you _____ **19** _____ and will protect you from the cold.
- For seasickness: Place a patch _____ **20** _____ instead of taking pills.





Part 3

Questions 21-23

Instructions to follow

- Complete the sentences. Write **NO MORE THAN TWO WORDS** for each answer.

- 21 Karen is planning to use an _____ for her presentation.
- 22 Karen is also going to prepare a power-point presentation as a _____
- 23 Karen wants a few websites to obtain more specific _____

Questions 24-28

Instructions to follow

- Choose your answers from the list and write the letters A-G next to the questions 24-28.

What recommendations does Dr Owen make about the websites?

- A. Must read
- B. Read recent articles
- C. Look at abstracts quickly
- D. Check links
- E. Scan references
- F. Useful



G Limited use

24 investment_IT.com

A B C D E F G

25 knowledge_journal.com

A B C D E F G

26 IT_knowledge_review.com

A B C D E F G

27 IT_online.com

A B C D E F G

28 NationalStatistics.com

A B C D E F G

Question 29-30

Instructions to follow

- Choose TWO letter A-E.

Which TWO things should be avoided in the presentation?

29 _____



- A Too much information at once
- B Irrelevant visuals
- C Small fonts
- D Too many colours
- E Talking fast

30

- A Too much information at once
- B Irrelevant visuals
- A Small fonts
- D Too many colours
- E Talking fast





Part 4

Questions 31-35

Instructions to follow

- Write NO MORE THAN TWO WORDS. Answer the following questions.

- 31 Who should take charge of the patient’s health?
- 32 What, in the speaker’s opinion, is the single greatest threat to health?
- 33 Which group in the study was most at risk of early death?
- 34 Which environmental hazard does the speaker find most under-rated?
- 35 What will be improved by an education campaign?

Questions 36-40

Instructions to follow

- Write NO MORE THAN TWO WORDS to complete the sentences.

- 36 Statistics quoted show that would prevent many 37
- 38 Exercise should be so find someone to join you in your activity.
- 39 One important way of preventing sports injury is by adequate
- 40 Injuries can also be reduced by using techniques.





Answer Keys

Listening Test 1

Part 1		Part 2		Part 3		Part 4	
Question	Answer	Question	Answer	Question	Answer	Question	Answer
1	Super cleaner	11	Padded	21	Long	31	Living entity
2	August 25 th	12	Corners	22	Thirty-five/ 35	32	Nutrients
3	Carpet cleaner	13	Special skill	23	Question-answer	33	Minerals
4	165 pounds	14	Learning toys	24	1 week/one week	34	Bedrock
5	Mr. Tidy	15	Disinfect	25	B	35	Subsoil
6	Quite good	16	Germs	26	D	36	Topsoil
7	1, 3 PM	17	C	27	Fovac	37	Pollution
8	Thursdays	18	A	28	Economy	38	Pest control
9	Air conditioner	19	C	29	University	39	Production practices
10	Music playing	20	B	30	2005	40	Predator



Listening Test 2

Part 1		Part 2		Part 3		Part 4	
Question	Answer	Question	Answer	Question	Answer	Question	Answer
1	A	11	A	21	A	31	Sun's position
2	A	12	C	22	C	32	Animal (s)
3	C	13	C	23	B	33	Religion (s)
4	Tuesday, Friday	14	B	24	A	34	(the) government
5	6, 7.30	15	C	25	B	35	North Africa
6	1 day	16	F	26	D	36	Varied
7	Level/classes	17	B	27	A	37	Temperature
8	Doherty	18	A	28	B	38	Sandglass
9	11.00	19	E	29	C	39	Limited
10	0117965478	20	D	30	D	40	Time



Listening Test 3

Part 1		Part 2		Part 3		Part 4	
Question	Answer	Question	Answer	Question	Answer	Question	Answer
1	Durham	11	B	21	M	31	Select
2	78483762	12	A	22	I	32	Invest
3	Trader	13	C	23	B	33	Research
4	17 brown	14	C	24	P	34	Sell
5	4065	15	B	25	Statistics	35	Buy
6	6 months	16	C	26	Course	36	Calculate
7	Washing machine	17	E	27	Scanning	37	29
8	750	18	02075624028	28	Exercises	38	Manufacturing
9	Water	19	27.50	29	B	39	Import prices
10	Noisy	20	3 hours	30	C	40	February 5 th



Listening Test 4

Part 1		Part 2		Part 3		Part 4	
Question	Answer	Question	Answer	Question	Answer	Question	Answer
1	95, Green lane	11	10	21	B	31	Dead
2	07779724868	12	Straightforward walking	22	C	32	Stock
3	WIL 948578269	13	Rock climbing	23	E	33	Feel comfortable
4	Four/4	14	Gave up	24	Organize questions	34	Dwell
5	Toyota	15	2	25	Conduct	35	Strongest offers
6	£170	16	School	26	3 rd April	36	D
7	International hotel	17	8	27	15/20	37	A
8	Breakdown, an accident	18	2	28	Eye contact	38	B
9	E	19	Exclusive	29	Visual aids	39	C
10	J	20	Large	30	Whiteboard	40	E



Listening Test 5

Part 1		Part 2		Part 3		Part 4	
Question	Answer	Question	Answer	Question	Answer	Question	Answer
1	Douglass	11	B	21	Last 40	31	Carbon
2	Hill Avenue	12	A	22	Sea gem	32	Forests
3	765482	13	C	23	Economic crisis	33	Transportation/transport
4	Low volume	14	A	24	Leases	34	Rubbish
5	Power cut	15	A	25	Global price	35	Promotion
6	Schneider SVV5002	16	B	26	Mature province	36	Culture
7	7 years	17	F	27	Fire extinguishers	37	Crime
8	B	18	C	28	Lifeboat stations	38	Air
9	C	19	E	29	Mock fire	39	Welfare
10	A	20	A	30	Building site	40	Traffic



Listening Test 6

Part 1		Part 2		Part 3		Part 4	
Question	Answer	Question	Answer	Question	Answer	Question	Answer
1	Supervisor	11	Community week	21	Mitchell	31	1960s
2	Regularly	12	Give up	22	66	32	Battery
3	List	13	Responsible	23	Education	33	1980
4	Communicate	14	Practical	24	994578ED	34	Academic
5	Objections	15	Mr. Tyler	25	C	35	10,000
6	Concerns	16	Street	26	B	36	A review
7	A	17	Kitchen	27	B	37	Test centers
8	C	18	B	28	A	38	Speaking
9	E	19	A	29	C	39	2005
10	G	20	C	30	A	40	Highly competitive



Listening Test 7

Part 1		Part 2		Part 3		Part 4	
Question	Answer	Question	Answer	Question	Answer	Question	Answer
1	Terminal	11	£85	21	Drums classical	31	B
2	Pantera	12	3 a month	22	Guitar classical	32	B
3	East	13	Thrillers	23	Drums rock	33	A
4	07765328 411	14	Comedy programmes	24	Violin country	34	Microclimate
5	Hotel	15	Parts	25	Piano opera	35	Concentration
6	Raincoat	16	Record	26	Flute jazz	36	Frost
7	Shoes	17	£ 71.99	27	Heart/heartbeat	37	Liquid
8	Mountain lives	18	Labour	28	Blood pressure/heartbeat	38	Supercooling
9	Chocolate	19	CDs	29	melodious	39	Mars
10	Calendar	20	Insurance	30	Cultures	40	Locations



Listening Test 8

Part 1		Part 2		Part 3		Part 4	
Question	Answer	Question	Answer	Question	Answer	Question	Answer
1	B	11	Table tennis	21	C	31	17 th century
2	B	12	100	22	B	32	English literature
3	A	13	12	23	A	33	Buried treasure
4	D	14	Street dance	24	C	34	Privateer
5	G	15	E	25	C	35	New York
6	Water festivals	16	B	26	Phoebe Payne	36	Pirates
7	Six	17	G	27	Nottingham	37	Piracy
8	Luck	18	Mandeville	28	Economics	38	Hanged
9	New year	19	Bury Gardens	29	C	39	Evidence
10	Ancient traditions	20	07942573279	30	A	40	Charity



Listening Test 9

Part 1		Part 2		Part 3		Part 4	
Question	Answer	Question	Answer	Question	Answer	Question	Answer
1	1/one	11	University	21	Novelty	31	Park
2	Edward Francis	12	Interesting	22	Economics benefits	32	Hope street
3	23 Cypress	13	Vocational	23	Commercial	33	Documentation
4	CB39NF	14	Careers	24	Congestion	34	Certification
5	Taxi	15	A	25	Lifestyles	35	Not flexible
6	Breakfast	16	C	26	Very negative	36	23.5%
7	Friday	17	B	27	The relationships	37	Current
8	C	18	A	28	Traditional skills	38	Savings
9	B	19	C	29	Women	39	Deposits
10	C	20	C	30	New languages	40	Automatically



Listening Test 10

Part 1		Part 2		Part 3		Part 4	
Question	Answer	Question	Answer	Question	Answer	Question	Answer
1	B	11	Meeting point	21	Tuesday and Wednesday	31	Negative impacts
2	D	12	Changing rooms	22	Career paths	32	Water pollution
3	B, D, E	13	Sports hall	23	Company websites	33	Backpacking
4	C	14	First aid	24	B	34	Ideals
5	B	15	Café lounge	25	A	35	Natural areas
6	14 th April	16	£850	26	B	36	Customs
7	Rainforest park	17	250	27	A	37	Nature conservations
8	Bush walking	18	Personal trainer	28	B	38	Food production
9	venomous snakes	19	weekdays	29	E	39	Rivers
10	(irritation) plants	20	50%	30	F	40	Japan



Listening Test 11

Part 1		Part 2		Part 3		Part 4	
Question	Answer	Question	Answer	Question	Answer	Question	Answer
1	Framlington	11	Windows open	21	Range	31	A
2	441192	12	Pickproof locking	22	1930s/ mid 1930s	32	C
3	5/ five nights	13	Peephole	23	Isolated	33	B
4	4/four	14	Don't know	24	Released	34	C
5	B	15	Window	25	Carrying capacity	35	A
6	C	16	Inventory	26	North	36	A
7	17 th March	17	C	27	15	37	B
8	716	18	A	28	A	38	A
9	15/ fifteenth	19	Suspended	29	D	39	C
10	FAPSJM15	20	Garage door	30	F (the above three in any order)	40	D



Listening Test 12

Part 1		Part 2		Part 3		Part 4	
Question	Answer	Question	Answer	Question	Answer	Question	Answer
1	C	11	3 hours	21	Electronic whiteboard	31	Patient. himself
2	A	12	Grey whales	22	Backup	32	Smoking
3	B	13	Hot springs	23	Background material	33	Young men
4	A	14	Swim very/ fast	24	C	34	The sun
5	C	15	Black	25	G	35	public health
6	B	16	14m/ meters	26	B	36	Healthy lifestyle
7	3/ three	17	The middle	27	F	37	Illnesses
8	A concert	18	Bright orange	28	D	38	Fun/ a pleasure
9	A cinema	19	Can't swim	29	A	39	Stretching (exercise)
10	A tour	20	Your arm	30	B	40	Cross training



If you score...

0 - 12

you are highly unlikely to get you may get an acceptable an acceptable score under I score under examination conditions and we recommend that you spend a lot of time improving I more practice or lessons your English before you take IELTS

13-26

you may get an acceptable score under examination conditions but we recommended that you think about having more practice or lessons before you take IELTS.

27-40

you are likely to get an acceptable score under examination conditions but remember that different institutions will find different scores acceptable.

